

**Legend**

- Order Limits Section 1
- Construction Traffic Route Section 1
- Trackout 50m
- Trackout
- Receptors Section 1
  - 0 - 20m
  - 0 - 50m
  - 0 - 100m
  - 0 - 200m
- Buffers Section 1
  - 20 m
  - 50 m
  - 100 m
  - 200 m
  - 350 m
- 0 - 350m

Infrastructure Planning (Applications: Prescribed Forms and Procedure) Regulations 2009 - Regulation 5(2)(a)

REV	DATE	BY	DESCRIPTION	CHK	APP
01	13/11/2019	LFS	FIRST ISSUE	SB	MM

DRAWING STATUS: **FINAL**

**WSP**

WSP House, 70 Chancery Lane, London, WC2A 1AF, UK,  
T+ 44 (0) 020 7314 5000  
wsp.com

CLIENT

**AQUIND**

PROJECT:

AQUIND Interconnector

TITLE:

Air Quality Chapter 23  
Figure 23.2 Construction Dust Assessment  
Section 1 Lovedean (Converter Station Area) Sheet 1 of 10

SCALE AT A3: 1:10000	CHECKED: SB	APPROVED: MM
PROJECT NO: 62100616	DESIGNED: LFS	DRAWN: LFS
DRAWING NO: EN020022-ES-23.2 - Sheet 1		DATE: 13/11/2019
REV NO: 01		

© WSP UK Ltd

Reproduced from Ordnance Survey digital map data © Crown copyright 2019. All rights reserved. Licence number 0100031673.

© Crown copyright material is reproduced with the permission of Land Registry under delegated authority from the Controller of HMSO. This material was last updated in 2019 and may not be copied, distributed, sold or published without the formal permission of Land Registry. Only an official copy of a title plan or register obtained from the Land Registry may be used for legal or other official purposes.

May contain public sector information licensed under the Open Government Licence v 3.0.

© OpenStreetMap contributors

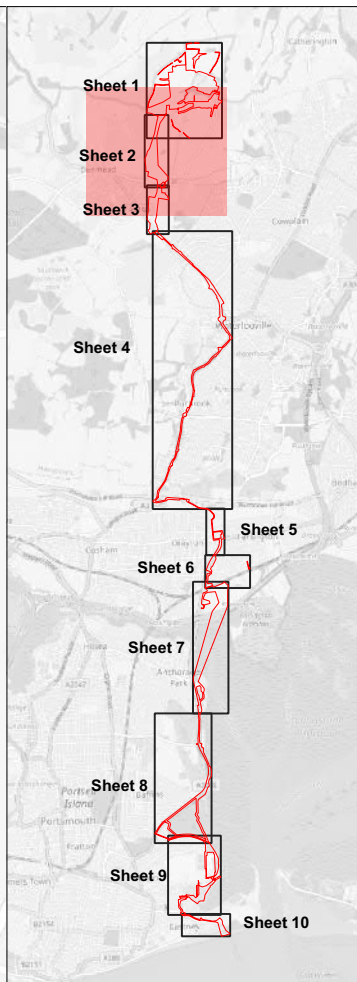
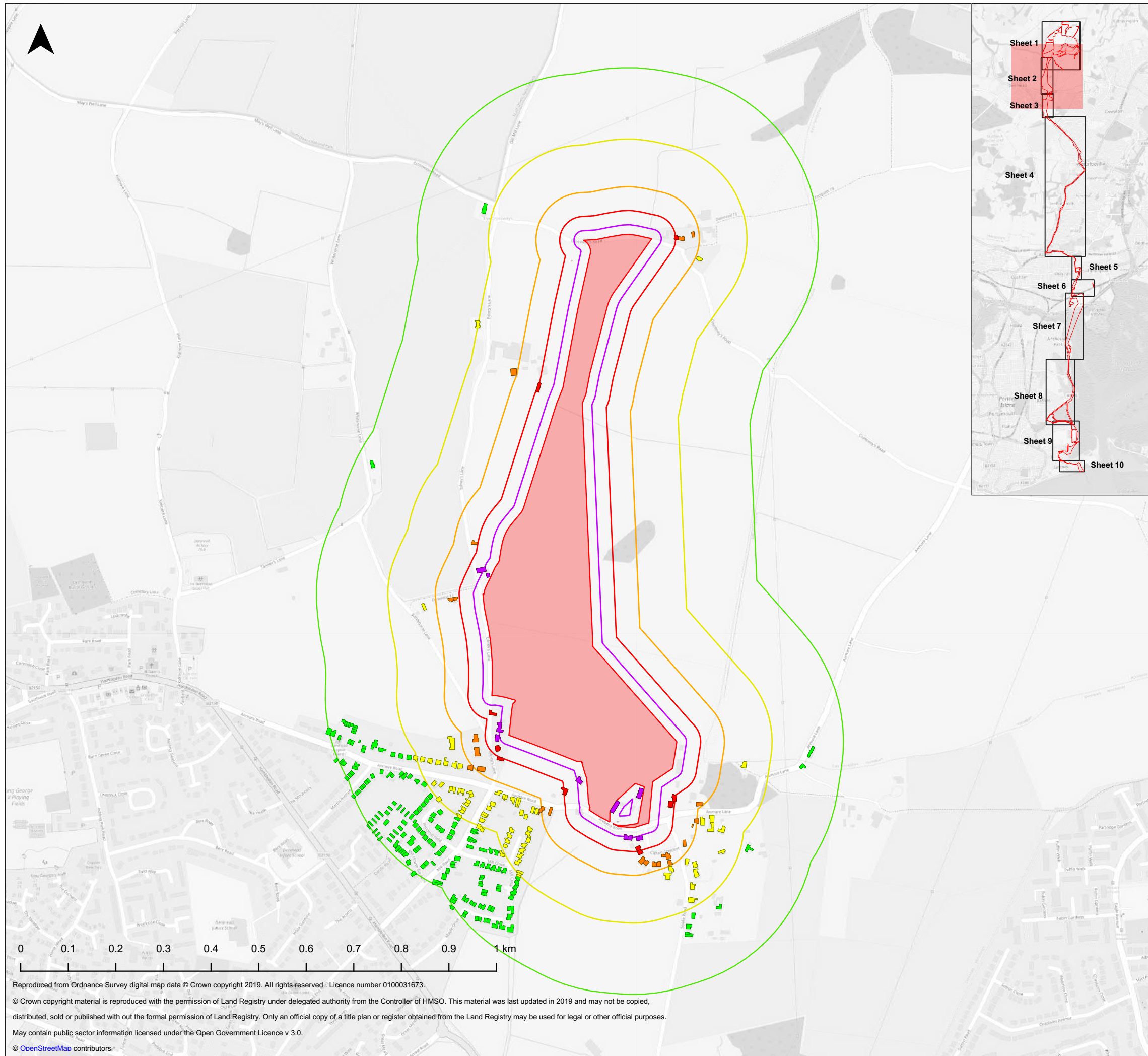

**Legend**

Order Limits Section 2	Buffers Section 2 20 m
Receptors Section 2 0 - 20m	50 m
0 - 50m	100 m
0 - 100m	200 m
0 - 200m	350 m
0 - 350m	

Infrastructure Planning (Applications: Prescribed Forms and Procedure) Regulations 2009 - Regulation 5(2)(a)

01	13/11/2019	LFS	FIRST ISSUE	SB	MM
REV	DATE	BY	DESCRIPTION	CHK	APP

DRAWING STATUS: **FINAL**

WSP House, 70 Chancery Lane, London, WC2A 1AF, UK,  
T+ 44 (0) 020 7314 5000  
wsp.com

CLIENT

PROJECT:

AQUIND Interconnector

TITLE:

Air Quality Chapter 23  
Figure 23.2 Construction Dust Assessment  
Section 2 Anmore Sheet 2 of 10

SCALE AT A3: 1:8000	CHECKED: SB	APPROVED: MM
PROJECT NO: 62100616	DESIGNED: LFS	DRAWN: LFS
		DATE: 13/11/2019

DRAWING NO: EN020022-ES-23.2 - Sheet 2	REV NO. 01
---	---------------

© WSP UK Ltd

Reproduced from Ordnance Survey digital map data © Crown copyright 2019. All rights reserved. Licence number 0100031673.

© Crown copyright material is reproduced with the permission of Land Registry under delegated authority from the Controller of HMSO. This material was last updated in 2019 and may not be copied, distributed, sold or published with out the formal permission of Land Registry. Only an official copy of a title plan or register obtained from the Land Registry may be used for legal or other official purposes.

May contain public sector information licensed under the Open Government Licence v 3.0.

© OpenStreetMap contributors

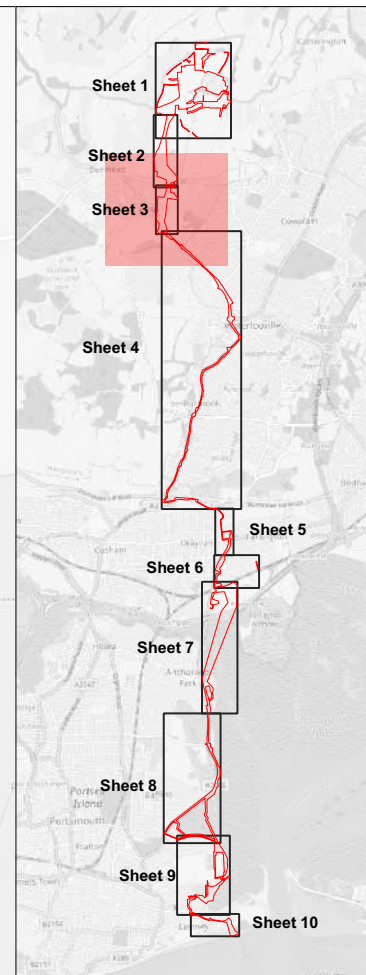
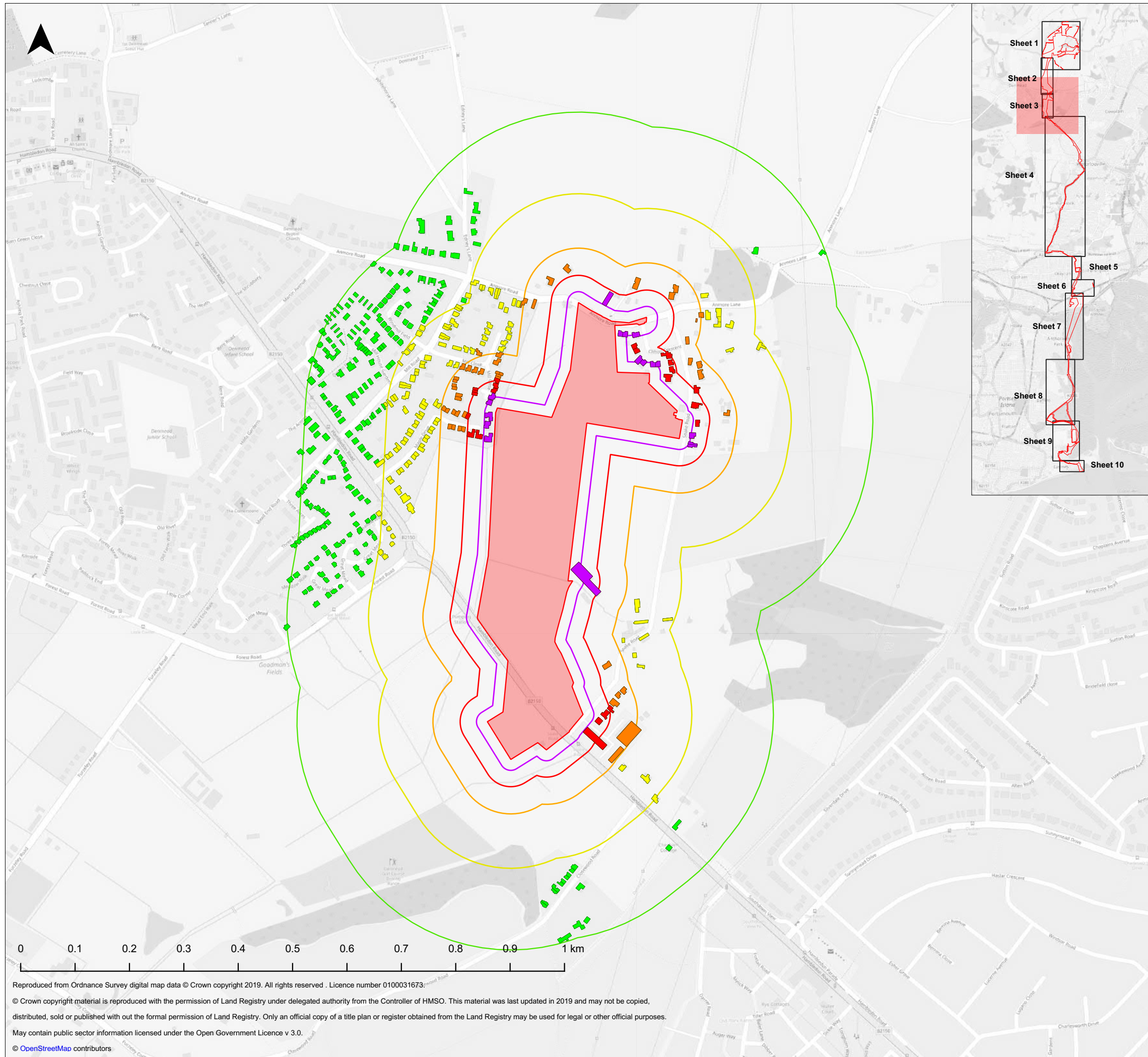

**Legend**

Order Limits Section 3	Buffers Section 3
0 - 20m	20 m
0 - 50m	50 m
0 - 100m	100 m
0 - 200m	200 m
0 - 350m	350 m

Receptors Section 3

Infrastructure Planning (Applications: Prescribed Forms and Procedure) Regulations 2009 - Regulation 5(2)(a)

REV	DATE	BY	DESCRIPTION	CHK	APP
01	13/11/2019	LFS	FIRST ISSUE	SB	MM

DRAWING STATUS: **FINAL**

WSP House, 70 Chancery Lane, London, WC2A 1AF, UK,  
T+ 44 (0) 020 7314 5000  
wsp.com

CLIENT

PROJECT:

**AQUIND Interconnector**

TITLE:

**Air Quality Chapter 23  
Figure 23.2 Construction Dust Assessment  
Section 3 Denmead/Kings Pond Meadow Sheet 3 of 10**

SCALE AT A3: 1:7000	CHECKED: SB	APPROVED: MM
PROJECT NO: 62100616	DESIGNED: LFS	DRAWN: LFS
DRAWING NO: EN020022-ES-23.2 - Sheet 3		DATE: 13/11/2019
REV NO: 01		

© WSP UK Ltd

Reproduced from Ordnance Survey digital map data © Crown copyright 2019. All rights reserved. Licence number 0100031673.  
 © Crown copyright material is reproduced with the permission of Land Registry under delegated authority from the Controller of HMSO. This material was last updated in 2019 and may not be copied, distributed, sold or published with out the formal permission of Land Registry. Only an official copy of a title plan or register obtained from the Land Registry may be used for legal or other official purposes.  
 May contain public sector information licensed under the Open Government Licence v 3.0.  
 © OpenStreetMap contributors

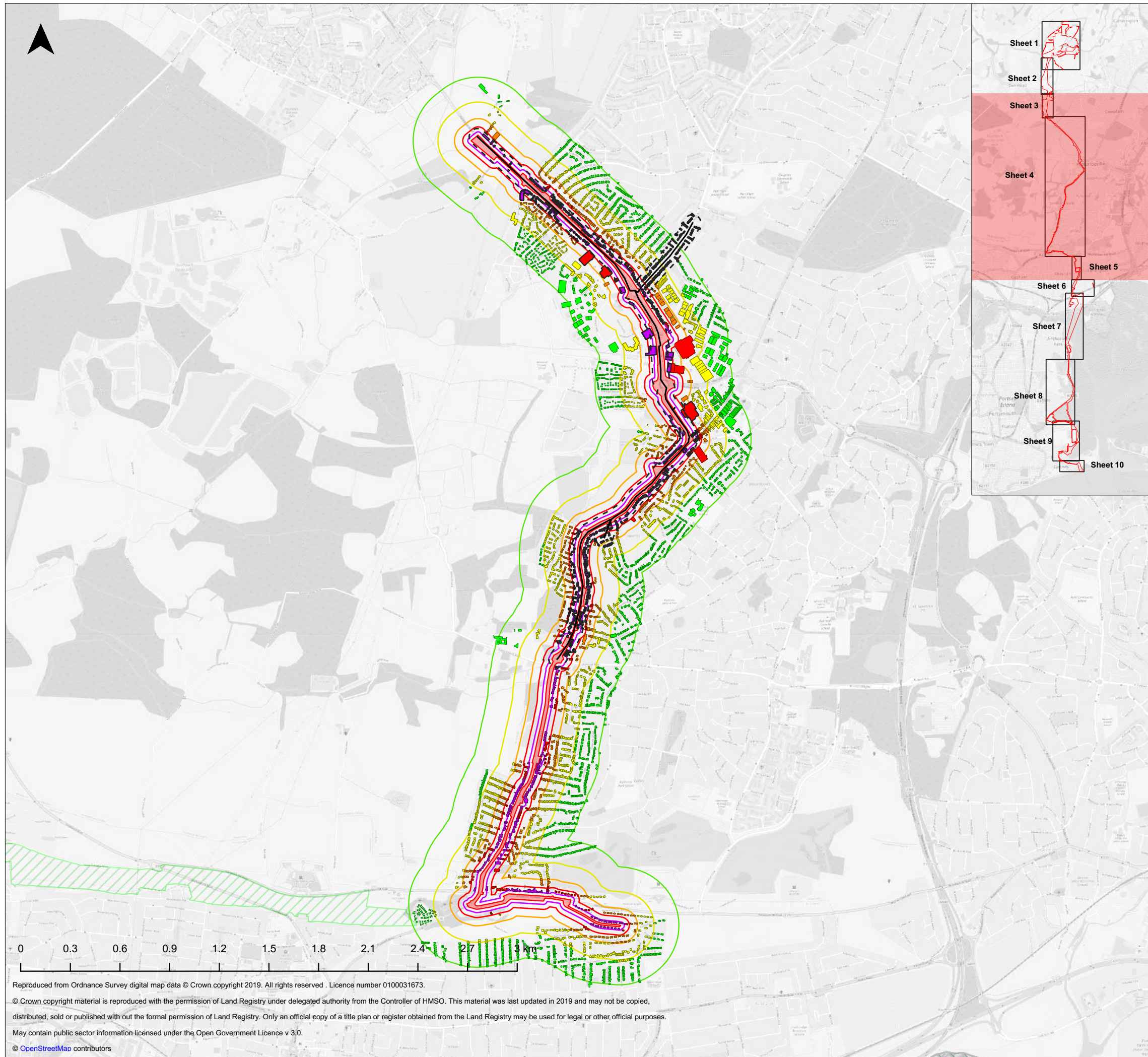

**Legend**

Order Limits Section 4	<b>Buffers Section 4</b>
Construction Traffic Route Section 4	20 m
Trackout 50m	50 m
<b>Receptors Section 4</b>	100 m
0 - 20m	200 m
0 - 50m	350 m
0 - 100m	<b>Nature Conservation</b>
0 - 200m	Wetland of International Importance (RAMSAR)
0 - 350m	Special Area of Conservation (SAC)
Trackout	Special Protection Area (SPA)
	Site of Special Scientific Interest (SSSI)

Infrastructure Planning (Applications: Prescribed Forms and Procedure) Regulations 2009 - Regulation 5(2)(a)

01	13/11/2019	LFS	FIRST ISSUE	SB	MM
REV	DATE	BY	DESCRIPTION	CHK	APP

DRAWING STATUS: **FINAL**



WSP House, 70 Chancery Lane, London, WC2A 1AF, UK,  
T+ 44 (0) 020 7314 5000  
wsp.com

CLIENT



PROJECT:

AQUIND Interconnector

TITLE:

Air Quality Chapter 23  
Figure 23.2 Construction Dust Assessment  
Section 4 Hambleton Road to Farlington Avenue Sheet 4  
of 10

SCALE AT A3: 1:23000	CHECKED: SB	APPROVED: MM
PROJECT NO: 62100616	DESIGNED: LFS	DRAWN: LFS
DRAWING NO: EN020022-ES-23.2 - Sheet 4		DATE: 13/11/2019
REV NO: 01		

© WSP UK Ltd

Reproduced from Ordnance Survey digital map data © Crown copyright 2019. All rights reserved . Licence number 0100031673.  
© Crown copyright material is reproduced with the permission of Land Registry under delegated authority from the Controller of HMSO. This material was last updated in 2019 and may not be copied, distributed, sold or published with out the formal permission of Land Registry. Only an official copy of a title plan or register obtained from the Land Registry may be used for legal or other official purposes.  
May contain public sector information licensed under the Open Government Licence v 3.0.  
© OpenStreetMap contributors

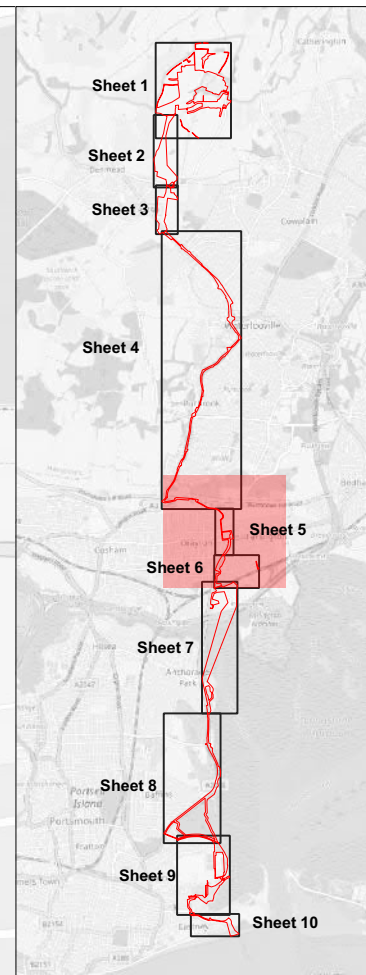
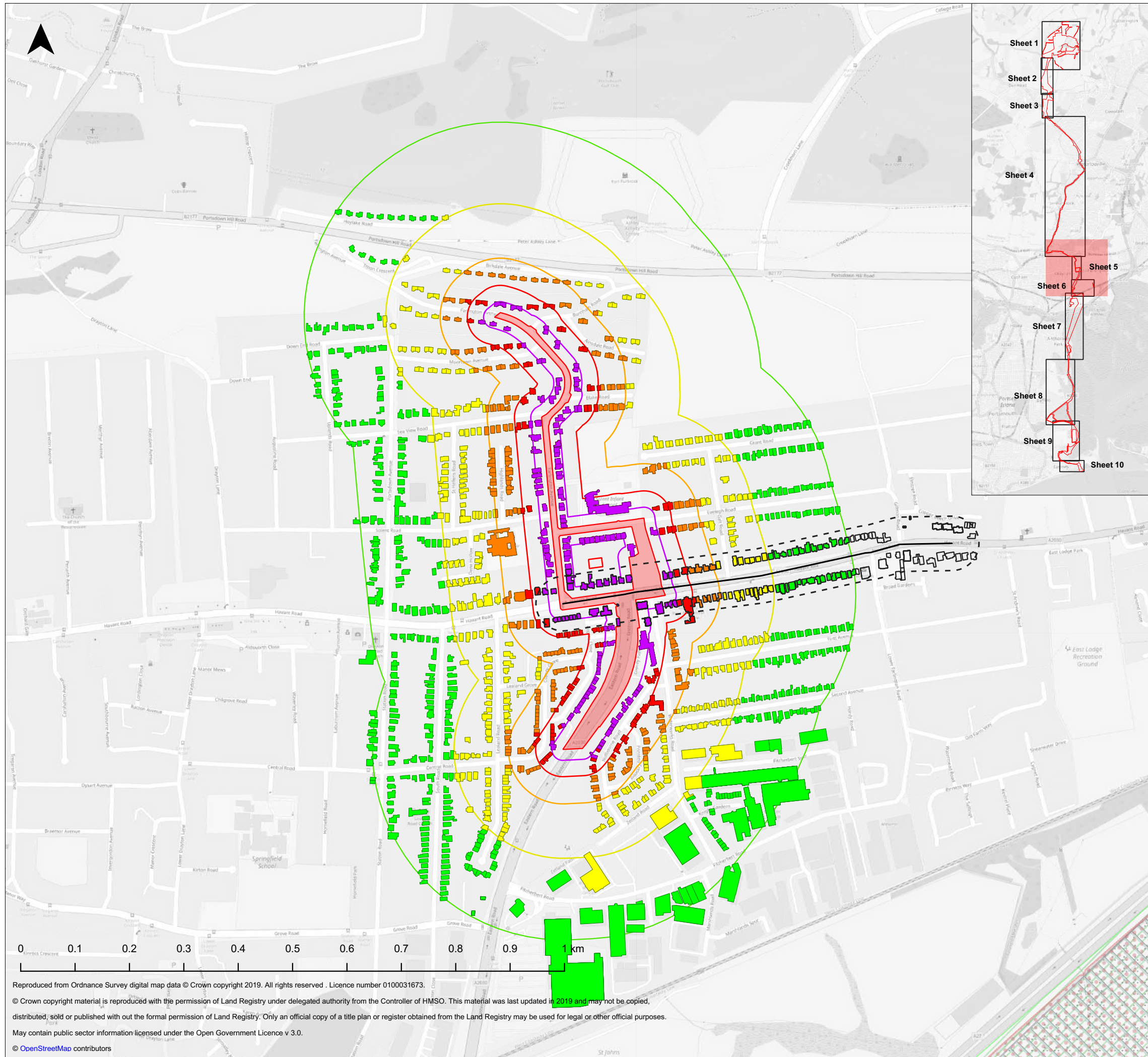

**Legend**

- Order Limits Section 5
- Construction Traffic Route Section 5
- Trackout 50m
- Receptors Section 5
  - 0 - 20m
  - 0 - 50m
  - 0 - 100m
  - 0 - 200m
  - 0 - 350m
- Trackout
- Buffers Section 5
  - 20 m
  - 50 m
  - 100 m
  - 200 m
  - 350 m
- Nature Conservation
  - Local Nature Reserve (LNR)
  - Wetland of International Importance (RAMSAR)
  - Special Protection Area (SPA)
  - Site of Special Scientific Interest (SSSI)

Infrastructure Planning (Applications: Prescribed Forms and Procedure) Regulations 2009 - Regulation 5(2)(a)

REV	DATE	BY	DESCRIPTION	CHK	APP
01	13/11/2019	LFS	FIRST ISSUE	SB	MM

DRAWING STATUS: **FINAL**



WSP House, 70 Chancery Lane, London, WC2A 1AF, UK,  
T+ 44 (0) 020 7314 5000  
wsp.com

CLIENT



PROJECT:

AQUIND Interconnector

TITLE:

Air Quality Chapter 23  
Figure 23.2 Construction Dust Assessment  
Section 5 Farlington Sheet 5 of 10

SCALE AT A3: 1:7000	CHECKED: SB	APPROVED: MM
PROJECT NO: 62100616	DESIGNED: LFS	DRAWN: LFS
DRAWING NO: EN020022-ES-23.2 - Sheet 5		DATE: 13/11/2019
REV NO. 01		

© WSP UK Ltd

Reproduced from Ordnance Survey digital map data © Crown copyright 2019. All rights reserved . Licence number 0100031673.  
 © Crown copyright material is reproduced with the permission of Land Registry under delegated authority from the Controller of HMSO. This material was last updated in 2019 and may not be copied, distributed, sold or published with out the formal permission of Land Registry. Only an official copy of a title plan or register obtained from the Land Registry may be used for legal or other official purposes.  
 May contain public sector information licensed under the Open Government Licence v 3.0.  
 © OpenStreetMap contributors

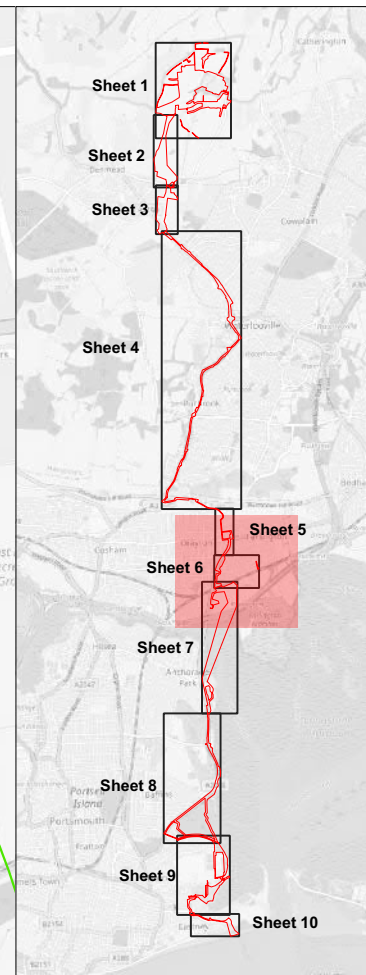
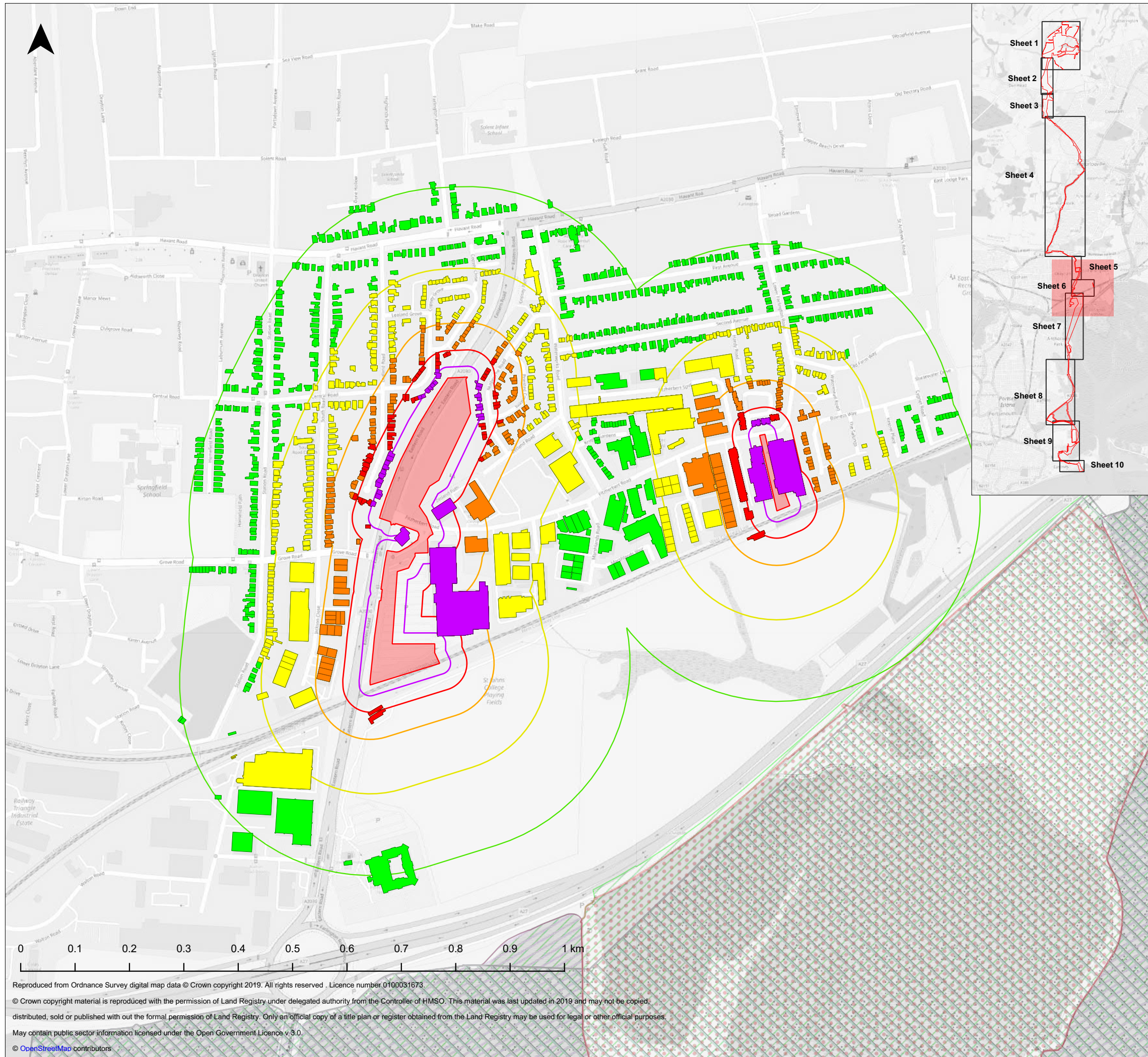

**Legend**

- Order Limits Section 6: Light red shaded area
- Receptors Section 6:
  - 0 - 20m: Purple
  - 0 - 50m: Red
  - 0 - 100m: Orange
  - 0 - 200m: Yellow
  - 0 - 350m: Green
- Buffers Section 6:
  - 20 m: Purple outline
  - 50 m: Red outline
- Nature Conservation:
  - Local Nature Reserve (LNR): Red dotted pattern
  - Wetland of International Importance (RAMSAR): Blue hatched pattern
  - Special Area of Conservation (SAC): Purple hatched pattern
  - Special Protection Area (SPA): Blue dashed pattern
  - Site of Special Scientific Interest (SSSI): Green hatched pattern

Infrastructure Planning (Applications: Prescribed Forms and Procedure) Regulations 2009 - Regulation 5(2)(a)

REV	DATE	BY	DESCRIPTION	CHK	APP
01	13/11/2019	LFS	FIRST ISSUE	SB	MM

DRAWING STATUS: **FINAL**



WSP House, 70 Chancery Lane, London, WC2A 1AF, UK,  
T+ 44 (0) 020 7314 5000  
wsp.com

CLIENT



PROJECT:  
**AQUIND Interconnector**

TITLE:  
**Air Quality Chapter 23  
Figure 23.2 Construction Dust Assessment  
Section 6 Zetland Field and Sainsbury's Car Park Sheet 6  
of 10**

SCALE AT A3: 1:7000	CHECKED: SB	APPROVED: MM
PROJECT NO: 62100616	DESIGNED: LFS	DRAWN: LFS
DRAWING NO: EN020022-ES-23.2 - Sheet 6		DATE: 13/11/2019
REV NO: 01		

© WSP UK Ltd

Reproduced from Ordnance Survey digital map data © Crown copyright 2019. All rights reserved. Licence number 0100031673.  
 © Crown copyright material is reproduced with the permission of Land Registry under delegated authority from the Controller of HMSO. This material was last updated in 2019 and may not be copied, distributed, sold or published with out the formal permission of Land Registry. Only an official copy of a title plan or register obtained from the Land Registry may be used for legal or other official purposes.  
 May contain public sector information licensed under the Open Government Licence v.3.0.  
 © OpenStreetMap contributors

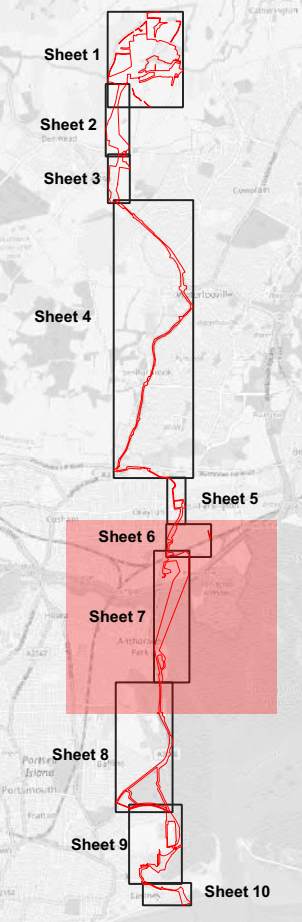
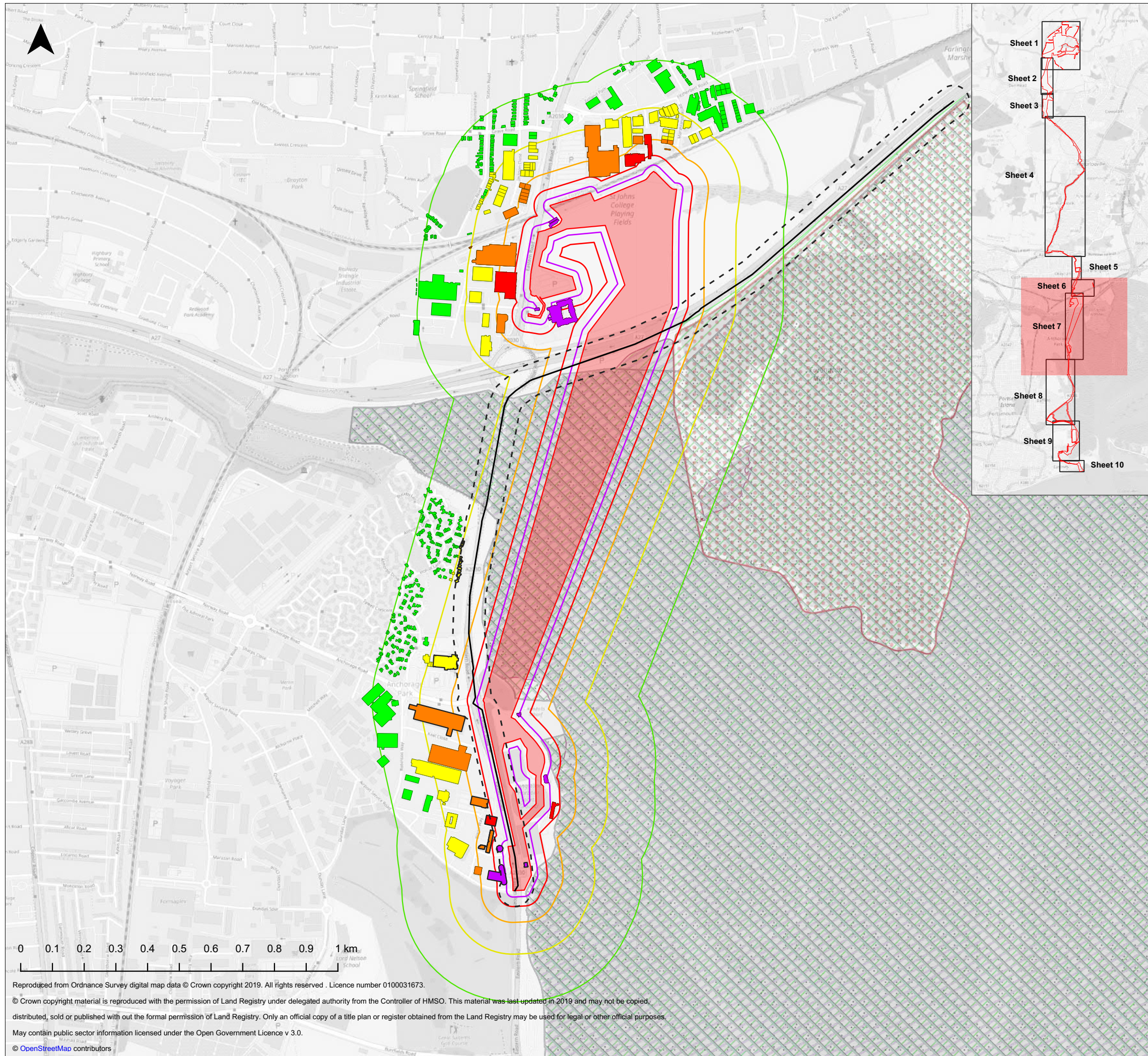

**Legend**

Order Limits Section 7	50 m
Construction Traffic Route Section 7	100 m
Trackout 50m	200 m
<b>Receptors Section 7</b>	350 m
0 - 20m	<b>Nature Conservation</b>
0 - 50m	Local Nature Reserve (LNR)
0 - 100m	Wetland of International Importance (RAMSAR)
0 - 200m	Special Area of Conservation (SAC)
0 - 350m	Special Protection Area (SPA)
Trackout	Site of Special Scientific Interest (SSSI)
<b>Buffers Section 7</b>	
20 m	

Infrastructure Planning (Applications: Prescribed Forms and Procedure) Regulations 2009 - Regulation 5(2)(a)

01	13/11/2019	LFS	FIRST ISSUE	SB	MM
REV	DATE	BY	DESCRIPTION	CHK	APP

DRAWING STATUS: **FINAL**



WSP House, 70 Chancery Lane, London, WC2A 1AF, UK,  
T+ 44 (0) 020 7314 5000  
wsp.com

CLIENT



PROJECT:

**AQUIND Interconnector**

TITLE:

**Air Quality Chapter 23  
Figure 23.2 Construction Dust Assessment  
Section 7 Farlington Junction to Airport Service Road  
Sheet 7 of 10**

SCALE AT A3: 1:12000	CHECKED: SB	APPROVED: MM
PROJECT NO: 62100616	DESIGNED: LFS	DRAWN: LFS
DRAWING NO: EN020022-ES-23.2 - Sheet 7		DATE: 13/11/2019
REV NO: 01		

Reproduced from Ordnance Survey digital map data © Crown copyright 2019. All rights reserved . Licence number 0100031673.  
© Crown copyright material is reproduced with the permission of Land Registry under delegated authority from the Controller of HMSO. This material was last updated in 2019 and may not be copied, distributed, sold or published with out the formal permission of Land Registry. Only an official copy of a title plan or register obtained from the Land Registry may be used for legal or other official purposes.  
May contain public sector information licensed under the Open Government Licence v 3.0.  
© OpenStreetMap contributors

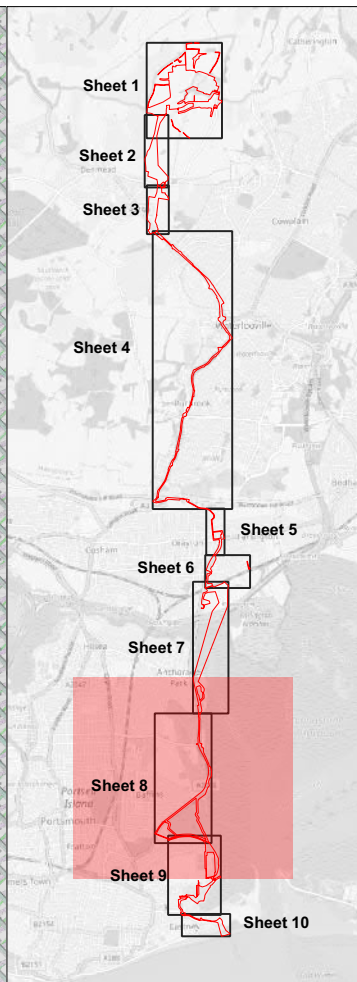
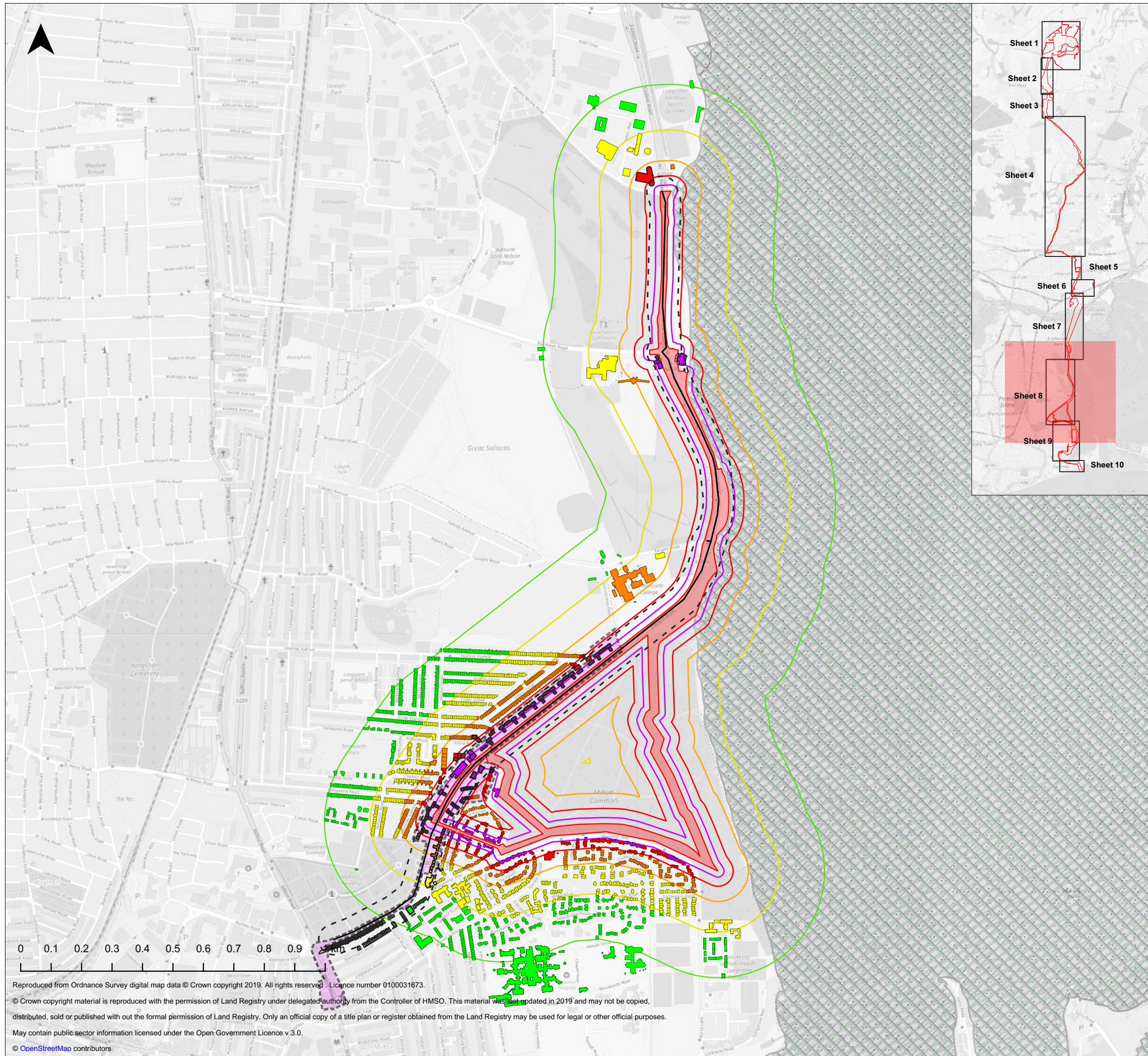

**Legend**

Order Limits Section 8	<b>Buffers Section 8</b>
Construction Traffic Route Section 8	20 m
Air Quality Management Area (AQMA)	50 m
Trackout 50m	100 m
<b>Receptors Section 8</b>	200 m
0 - 20m	350 m
0 - 50m	<b>Nature Conservation</b>
0 - 100m	Wetland of International Importance (RAMSAR)
0 - 200m	Special Area of Conservation (SAC)
0 - 350m	Special Protection Area (SPA)
Trackout	Site of Special Scientific Interest (SSSI)

Infrastructure Planning (Applications: Prescribed Forms and Procedure) Regulations 2009 - Regulation 5(2)(a)

01	13/11/2019	LFS	FIRST ISSUE	SB	MM
REV	DATE	BY	DESCRIPTION	CHK	APP

DRAWING STATUS: **FINAL**

**WSP**

WSP House, 70 Chancery Lane, London, WC2A 1AF, UK,  
T+ 44 (0) 020 7314 5000  
wsp.com

CLIENT

**AQUIND**

PROJECT:

**AQUIND Interconnector**

TITLE:

**Air Quality Chapter 23  
Figure 23.2 Construction Dust Assessment  
Section 8 Eastern Road (adjacent to Great Salterns Golf Course) to Moorings Way Sheet 8 of 10**

SCALE AT A3: 1:12500	CHECKED: SB	APPROVED: MM
PROJECT NO: 62100616	DESIGNED: LFS	DRAWN: LFS
DRAWING NO: EN020022-ES-23.2 - Sheet 8		DATE: 13/11/2019
REV NO. 01		

© WSP UK Ltd

Reproduced from Ordnance Survey digital map data © Crown copyright 2019. All rights reserved. Licence number 0100031673.  
© Crown copyright material is reproduced with the permission of Land Registry under delegated authority from the Controller of HMSO. This material was last updated in 2019 and may not be copied, distributed, sold or published with out the formal permission of Land Registry. Only an official copy of a title plan or register obtained from the Land Registry may be used for legal or other official purposes.  
May contain public sector information licensed under the Open Government Licence v 3.0.  
© OpenStreetMap contributors



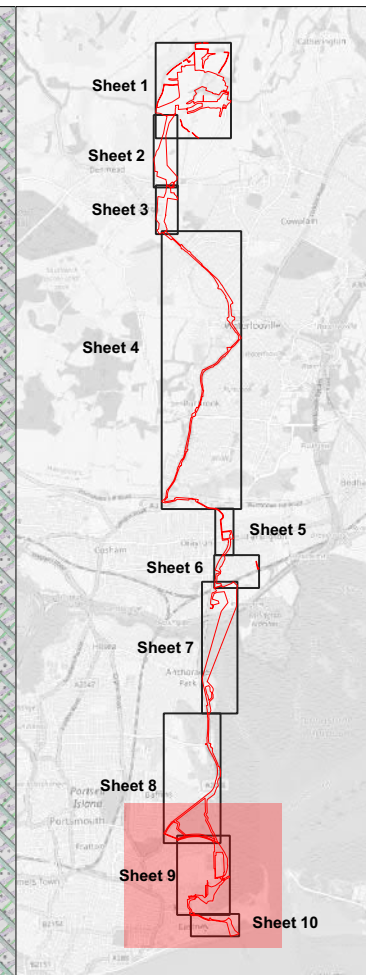
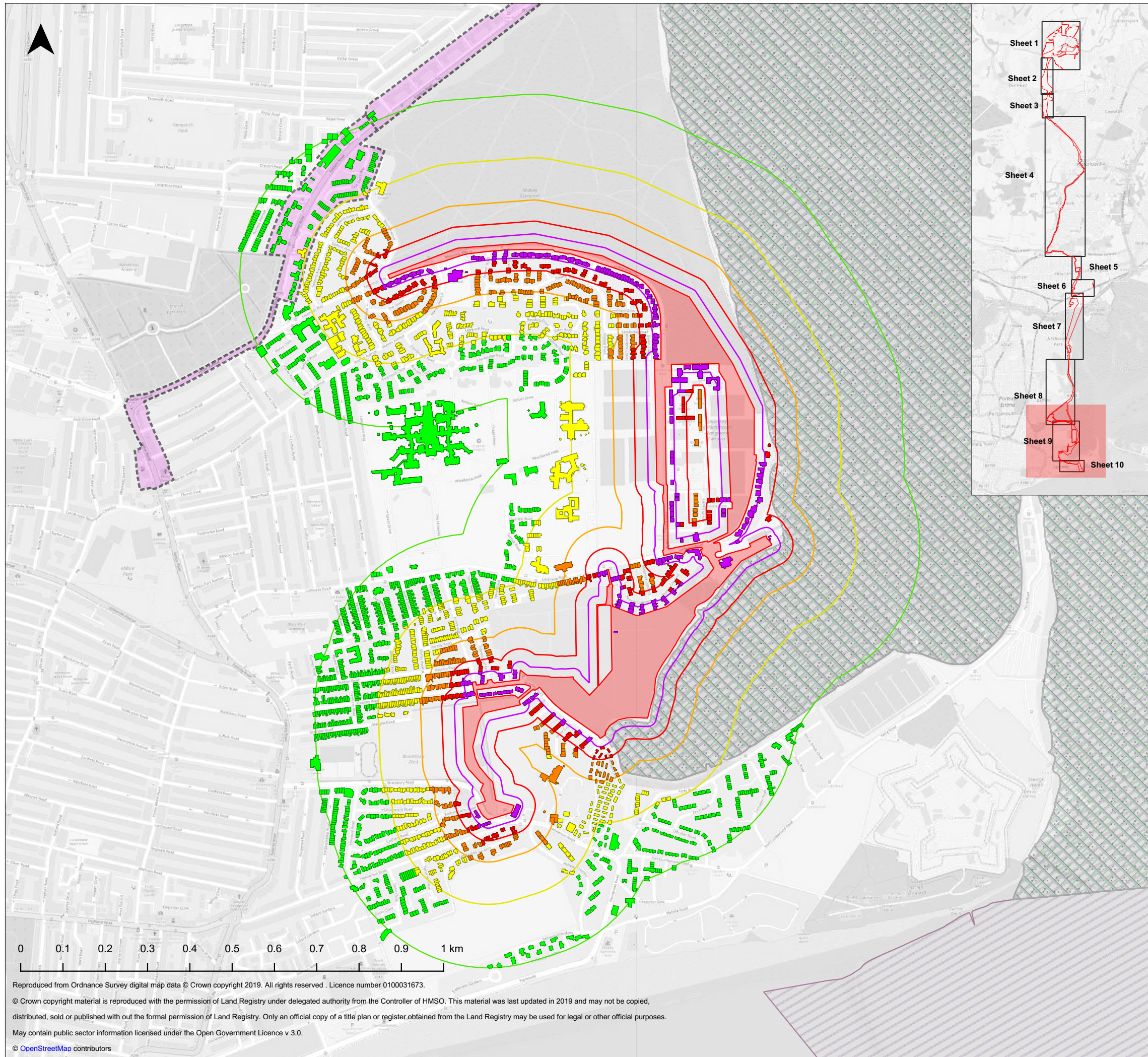

**Legend**

- Order Limits Section 9
- Air Quality Management Area (AQMA)
- Receptors Section 9**
- 0 - 20m
- 0 - 50m
- 0 - 100m
- 0 - 200m
- 0 - 350m
- Buffers Section 9**
- 20 m
- 50 m
- 100 m
- 200 m
- 350 m
- Nature Conservation**
- Wetland of International Importance (RAMSAR)
- Special Area of Conservation (SAC)
- Special Protection Area (SPA)
- Site of Special Scientific Interest (SSSI)

Infrastructure Planning (Applications: Prescribed Forms and Procedure) Regulations 2009 - Regulation 5(2)(a)

REV	DATE	BY	DESCRIPTION	CHK	APP
01	13/11/2019	LFS	FIRST ISSUE	SB	MM

DRAWING STATUS: **FINAL**



WSP House, 70 Chancery Lane, London, WC2A 1AF, UK,  
T+ 44 (0) 020 7314 5000  
wsp.com

CLIENT



PROJECT:

AQUIND Interconnector

TITLE:

Air Quality Chapter 23  
Figure 23.2 Construction Dust Assessment  
Section 9 Moorings Way to Bransbury Road Sheet 9 of 10

SCALE AT A3: 1:9000	CHECKED: SB	APPROVED: MM
PROJECT NO: 62100616	DESIGNED: LFS	DRAWN: LFS
DRAWING NO: EN020022-ES-23.2 - Sheet 9		DATE: 13/11/2019
REV NO. 01		

© WSP UK Ltd

Reproduced from Ordnance Survey digital map data © Crown copyright 2019. All rights reserved . Licence number 0100031673.  
© Crown copyright material is reproduced with the permission of Land Registry under delegated authority from the Controller of HMSO. This material was last updated in 2019 and may not be copied, distributed, sold or published with out the formal permission of Land Registry. Only an official copy of a title plan or register obtained from the Land Registry may be used for legal or other official purposes.  
May contain public sector information licensed under the Open Government Licence v 3.0.  
© OpenStreetMap contributors

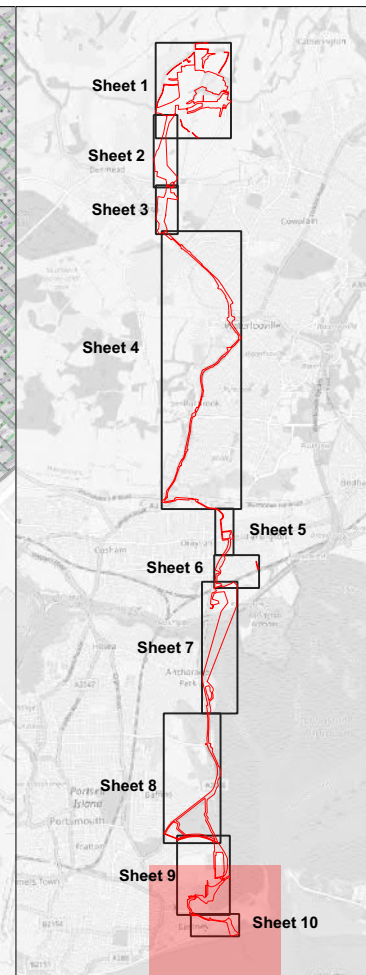
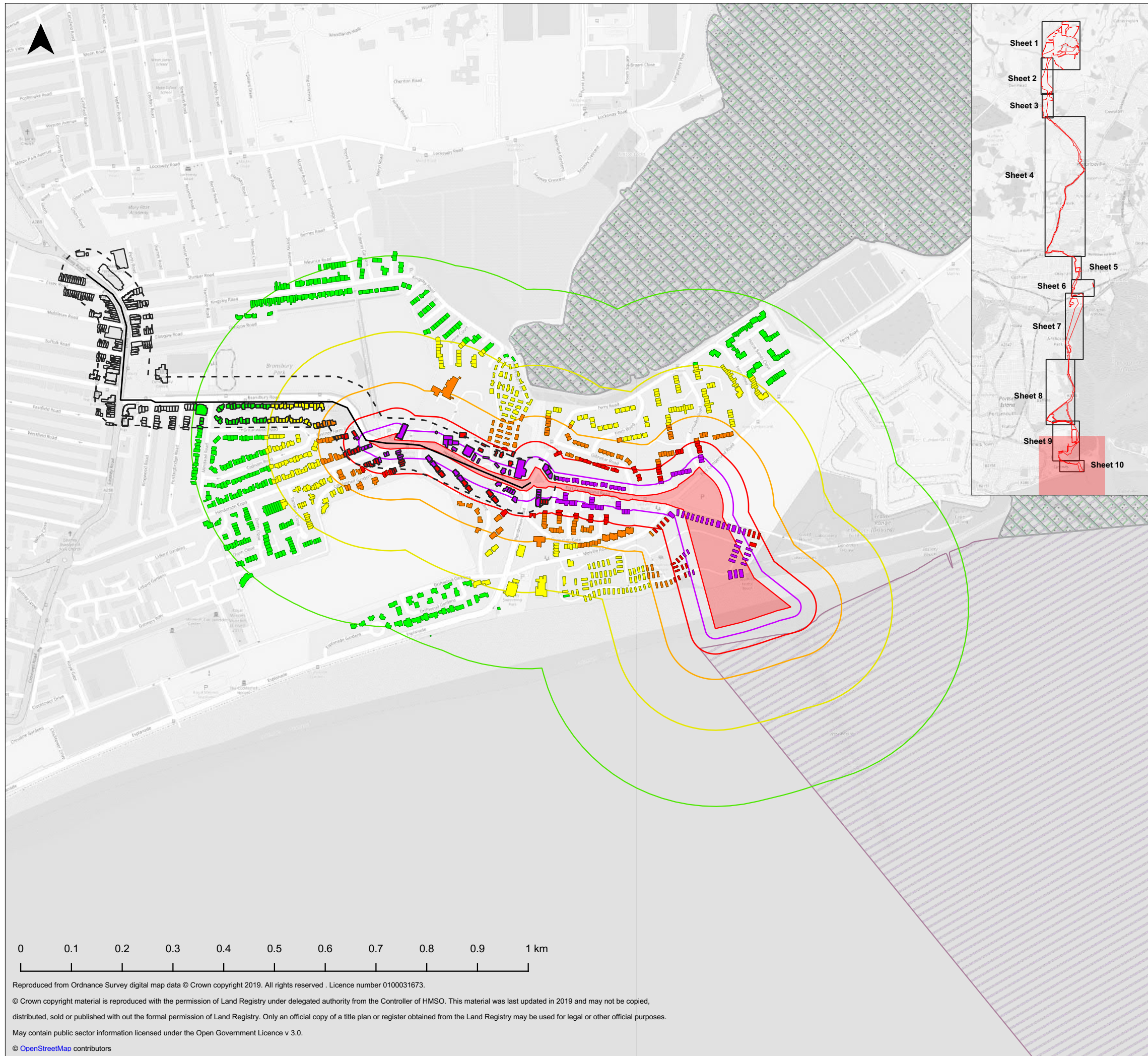

**Legend**

- Order Limits Section 10**
  - Order Limits Section 10 (Red outline)
- Construction Traffic Route Section 10**
  - Construction Traffic Route Section 10 (Black line)
- Trackout 50m**
  - Trackout 50m (Dashed black line)
- Receptors Section 10**
  - 0 - 20m (Purple)
  - 0 - 50m (Red)
  - 0 - 100m (Orange)
  - 0 - 200m (Yellow)
  - 0 - 350m (Green)
  - Trackout (White)
- Buffers Section 10**
  - 20 m (Purple)
  - 50 m (Red)
  - 100 m (Orange)
  - 200 m (Yellow)
  - 350 m (Green)
- Nature Conservation**
  - Wetland of International Importance (RAMSAR) (Blue hatched)
  - Special Area of Conservation (SAC) (Purple hatched)
  - Special Protection Area (SPA) (Blue dotted)
  - Site of Special Scientific Interest (SSSI) (Green hatched)

Infrastructure Planning (Applications: Prescribed Forms and Procedure) Regulations 2009 - Regulation 5(2)(a)

REV	DATE	BY	DESCRIPTION	CHK	APP
01	13/11/2019	LFS	FIRST ISSUE	SB	MM

DRAWING STATUS: **FINAL**



WSP House, 70 Chancery Lane, London, WC2A 1AF, UK,  
T+ 44 (0) 020 7314 5000  
wsp.com

CLIENT



PROJECT:

**AQUIND Interconnector**

TITLE:

**Air Quality Chapter 23  
Figure 23.2 Construction Dust Assessment  
Section 10 Eastney (Landfall) Sheet 10 of 10**

SCALE AT A3: 1:7500	CHECKED: SB	APPROVED: MM
PROJECT NO: 62100616	DESIGNED: LFS	DRAWN: LFS
DRAWING NO: EN020022-ES-23.2 - Sheet 10		DATE: 13/11/2019
REV NO: 01		

Reproduced from Ordnance Survey digital map data © Crown copyright 2019. All rights reserved . Licence number 0100031673.  
© Crown copyright material is reproduced with the permission of Land Registry under delegated authority from the Controller of HMSO. This material was last updated in 2019 and may not be copied, distributed, sold or published with out the formal permission of Land Registry. Only an official copy of a title plan or register obtained from the Land Registry may be used for legal or other official purposes.  
May contain public sector information licensed under the Open Government Licence v 3.0.  
© OpenStreetMap contributors